

## Topgolf Parking Demand Calculation

October 6, 2014

The following calculation of parking demand corresponds to the attached floor plan of Topgolf.

The use types on the floor plans have been translated into use types listed in the Zoning Ordinance.

	<b>Units</b> (sf, occupancy)	<b>Zoning Ordinance</b> <b>Use</b>	<b>Zoning Ordinance</b> <b>Parking Standard</b>	<b>Parking Spaces</b> <b>Required</b>
<b>Lower Level</b>				
Hitting Bays	34 tee bays	Golf driving range	1.5 space/tee	51
Lounge and Bar	1,637 sf	Bars and Drinking	1 space/50 sf	33
Beverage Service Area	420 sf	Places		8
Office and Work Room	1,317	Office, Professional	1 space/250 sf	6
subtotal				<b>98</b>
<b>Main Level</b>				
Hitting Bays	34 tee bays	Golf driving range	1.5 space/tee	51
Event Space	2,920 sf Max occ of 196	Assumes 95 percent of guests drive to/from the site with an average vehicle occupancy of 1.2.		155
Main Bar & Seating Area	1,751 sf	Bars and Drinking	1 space/50 sf	35
Beverage Service Area	287 sf	Places		6
subtotal				<b>247</b>
<b>Upper Level</b>				
Hitting Bays	34 tee bays	Golf driving range	1.5 space/tee	51
Lounge	244 sf	Bars and Drinking	1 space/50 sf	5
Beverage Service Area	380 sf	Places		7
Offices	1,006 sf	Office, Professional	1 space/250 sf	4
Roof Terrace	2,648 sf	Enclosed Outdoor Seating	1 space/100 sf	27
subtotal				<b>94</b>
<b>Total Parking Demand</b>				<b>439</b>

Lower Level

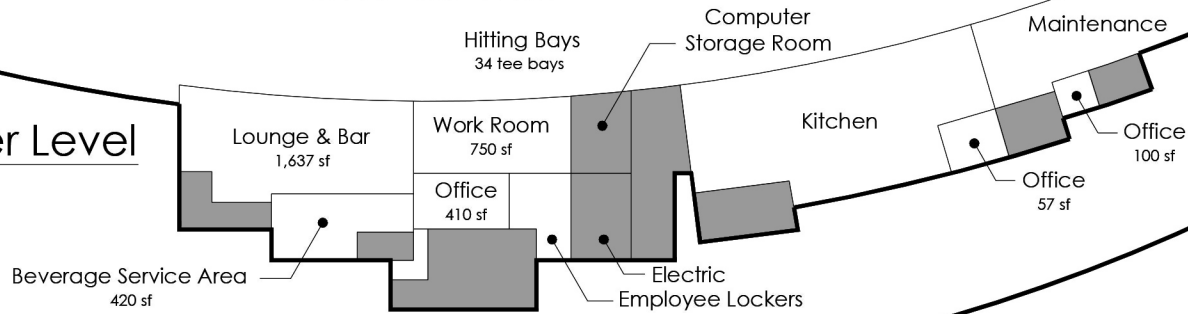

Main Level

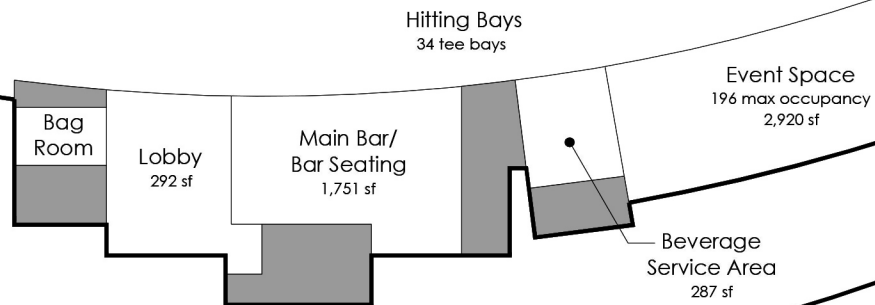

Upper Level

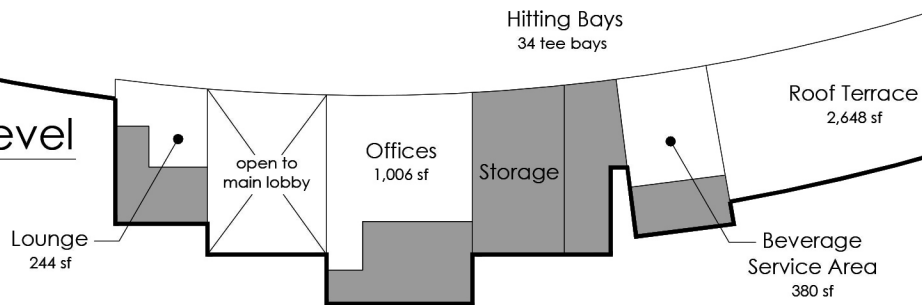

■ non-entertainment space including storage, mechanical, stairs, elevators, and restrooms

# Parcel 49 - Parking Analysis

TOP GOLF FLOOR PLANS

July 2014

